

SPLAT

804A-L3142B-01



Recessed ceiling SPLAT LED SMD 42W 3700lm CRI80 3000K 90° White

indeluž

SPLAT is a family of luminaires ceiling registable 60x60 low degree of glare (prismatic diffuser) and the possibility of regulation, also by crepuscular detector. This family of luminaires is the ideal solution for LED lighting in offices, classrooms and other working areas. Also for areas where it is not possible to embed, as the SPLAT luminaires have been configured in three versions: recessed, downlights and surface-shaped lamp.

GENERAL DATA

Category	Recessed
Family	Splat
Finish	[01] White
Location	Indoor
Installation	Ceiling
Body material	Aluminum
Diffuser material	Prismatic methacrylate
Frame material	Aluminum
ETIM class	EC000282
EAN	8433264071554

LIGHT SOURCES

LED SMD

Luminous flux	3700lm
Light source power	42 W
Color temperature	3000K
CRI	80
Color consistency	3 SDCM
Energy efficiency	G (3000K)

LIGHT BEAMS

Beam	90° - Direct symmetric
------	------------------------

TECHNICAL DATA

Dimensions	Height x Width x Length (mm): 8 x 595 x 595
IP	IP20
Protection class	Class II
Frequency	50/60 Hz
Input voltage	220-240V AC V
Power factor	0.9
Auxiliary gear	Electronic
UGR	19
Lifetime	40,000 h
LED lifetime L	80
LED lifetime B	20
Weight	3.85 Kg
ECORAE category I	LED-B

NOTES

For modular false ceiling (600x600)

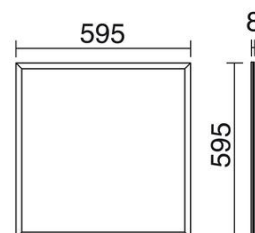

SPLAT

804A-L3142B-01

Recessed ceiling SPLAT LED SMD 42W 3700lm CRI80 3000K 90° White

indeluž

PHOTOMETRIC DATA

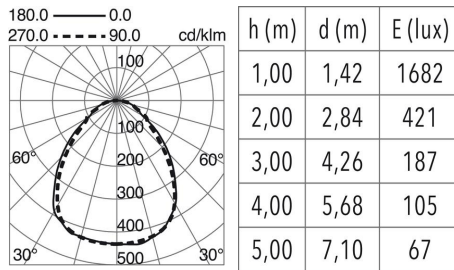

RECOMMENDED ACCESSORIES

A20B-583-01	Material	Aluminum
Kit Surface HIMMEL,SPLAT White	Finish	[01] White

605x605
±50

A20B-804-38	Material	Aluminum
Kit suspension SPLAT Zinc plated steel	Finish	[38] Zinc plated steel



COMPLEMENTARY IMAGES

