

TURT

1002A-L5120A4D-01-32



Recessed ceiling tilt TURT Medium Dali LED COB 18.60W 2389lm(1540lm) CRI95 3250K 40° White Chrome

indeluž

TURT is a new projector with COB LED, specially inspired for retail applications, among others. Available in CRI90 with color temperatures 2700K, 3000K and 4000K, and CRI95 for FASHION applications (3250K). You can choose between 20°, 40° and 55° optics in a single size that allows 8.8W and 18.6W wattages. In terms of dimming, TURT offers a wide range of options: Phase cut-off, Push/1-10V, DALI and Casambi. As for its installation, this is a projector that is recessed in the ceiling and has the versatility of being able to remain totally or partially inside the recessing box and illuminate zenithally as a downlight or be completely extracted outside the recessing to be oriented up to 80° vertically and rotate 355° horizontally. It is available in white and white or chrome trim and allows the use of anti-glare louvers and prismatic filters.



GENERAL DATA

Category	Recessed
Family	Turt
Finish	[01] White/[32] Chrome
Location	Indoor
Installation	Ceiling
Body material	Aluminum
Diffuser material	Transparent polycarbonate
Frame material	Polycarbonate
Reflector material	Metallic polycarbonate
ETIM class	EC001744
EAN	8433264209964

LIGHT SOURCES

LED COB	
Luminous flux	2389lm
Total flux	1540lm
Light source power	18.6 W
Color temperature	3250K
CRI	95
Color consistency	3 SDCM
Energy efficiency	E (3250K)

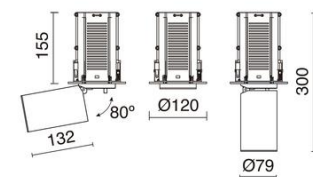

LIGHT BEAMS

Beam	40° - Direct symmetric
------	------------------------

TECHNICAL DATA

Dimensions	Diameter x Height (mm): 120 x 132
IP	IP20
Protection class	Class II
Frequency	50/60 Hz
Dimmable	Dali
Input voltage	110-240V AC V
Total wattage	20 W
Output current	500 mA
Power factor	0.95
Auxiliary gear	Electronic
Auxiliary equipment brand	TCI
Lifetime	55,000 h
LED lifetime L	70
LED lifetime B	50

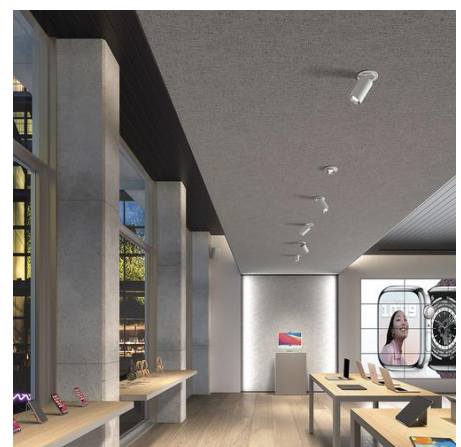

TURT

1002A-L5120A4D-01-32



Recessed ceiling tilt TURT Medium Dali LED COB 18.60W 2389lm(1540lm) CRI95 3250K 40° White Chrome

indeluž

Weight	0.88 Kg
Tilt angle	80.0 °
Rotation angle	355.0 °
Cut hole dimensions	Diameter x Height (mm): 105 x 150

PHOTOMETRIC DATA

